

仕 様 書

KC6ABxx

RJ45 モジュラジャック Cat6

株式会社 S a n k o I B

〒105-0014 東京都港区芝 1-5-9 (住友不動産芝ビル 2 号館)

TEL : 03-5730-2530 FAX : 03-5730-2536



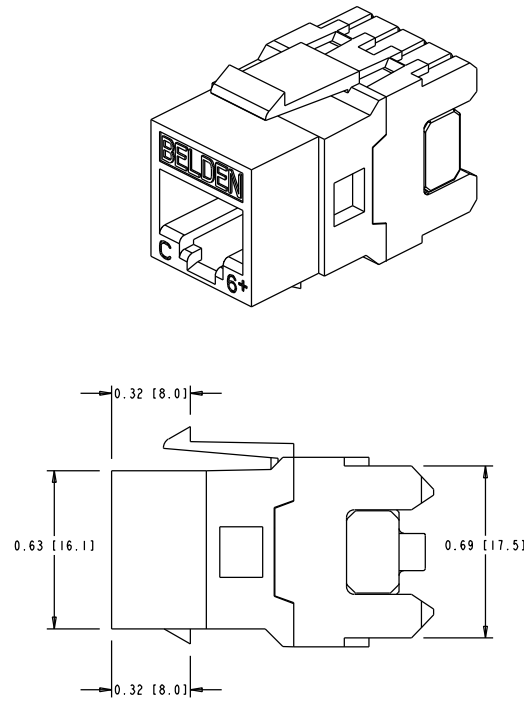
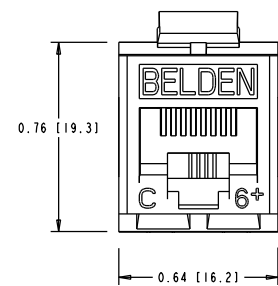
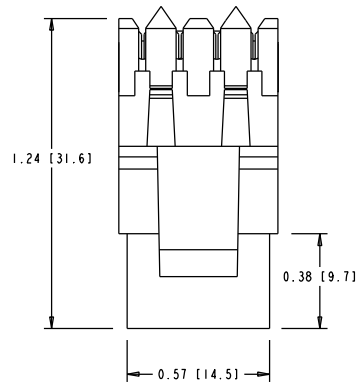

- NOTES
01. ALL DIMENSIONS ARE IN INCHES AND [MILLIMETERS].
 02. ALL DIMENSIONS SHOWN AS REFERENCE ONLY.

DATE	2008 JUN 30		
DES/DRW	APP	REV	
THIS DRAWING SUPERSEDES IBDN303			
QA	BL	A	
ADD NEW COLORS (DARK). ADD SUFFIX T1A606 TO EXISTING LIGHT COLORS. UPDATE DESCRIPTIONS.			
A.D.		B	

INFORMATION SUR LE PRODUIT
PRODUCT INFO

NUMÉRO DE PIÈCE PART NUMBER	CODE DU PRODUIT PRODUCT CODE	DESCRIPTION
AX101318	NXM6KUSAB-01	KEYCONNECT, 8 PIN, CAT6+, T568A/B, NON-K, GREY
AX101319	NXM6KUSAB-02	KEYCONNECT, 8 PIN, CAT6+, T568A/B, NON-K, ALMOND
AX101320	NXM6KUSAB-14	KEYCONNECT, 8 PIN, CAT6+, T568A/B, NON-K, ELEC WHITE
AX101321	NXM6KUSAB-04	KEYCONNECT, 8 PIN, CAT6+, T568A/B, NON-K, BLACK
AX101322	NXM6KUSAB-05	KEYCONNECT, 8 PIN, CAT6+, T568A/B, NON-K, ORANGE T1A606
AX101323	NXM6KUSAB-06	KEYCONNECT, 8 PIN, CAT6+, T568A/B, NON-K, RED T1A606
AX101324	NXM6KUSAB-07	KEYCONNECT, 8 PIN, CAT6+, T568A/B, NON-K, YELLOW T1A606
AX101325	NXM6KUSAB-08	KEYCONNECT, 8 PIN, CAT6+, T568A/B, NON-K, GREEN T1A606
AX101326	NXM6KUSAB-09	KEYCONNECT, 8 PIN, CAT6+, T568A/B, NON-K, BLUE T1A606
AX101327	NXM6KUSAB-10	KEYCONNECT, 8 PIN, CAT6+, T568A/B, NON-K, PURPLE T1A606
AX101328	NXM6KUSAB-11	KEYCONNECT, 8 PIN, CAT6+, T568A/B, NON-K, BROWN T1A606
AX103076	NXM6KUSAB-12	KEYCONNECT, 8 PIN, CAT6+, T568A/B, NON-K, IVORY
AX104189	NXM6KUSAB-20	KEYCONNECT, 8 PIN, CAT6+, T568A/B, NON-K, ORANGE
AX104190	NXM6KUSAB-21	KEYCONNECT, 8 PIN, CAT6+, T568A/B, NON-K, RED
AX104191	NXM6KUSAB-22	KEYCONNECT, 8 PIN, CAT6+, T568A/B, NON-K, YELLOW
AX104192	NXM6KUSAB-23	KEYCONNECT, 8 PIN, CAT6+, T568A/B, NON-K, GREEN
AX104193	NXM6KUSAB-24	KEYCONNECT, 8 PIN, CAT6+, T568A/B, NON-K, BLUE
AX104194	NXM6KUSAB-25	KEYCONNECT, 8 PIN, CAT6+, T568A/B, NON-K, PURPLE
AX104195	NXM6KUSAB-26	KEYCONNECT, 8 PIN, CAT6+, T568A/B, NON-K, BROWN

PROPRIÉTÉ INTELLECTUELLE
L'information contenue dans ce document est la propriété de BELDEN INC.
Sauf si spécifié par une autorisation écrite de BELDEN INC, la personne
qui consulte ce document : (1) doit garder confidentielle toute l'information
contenue dans ce document et doit protéger en tout ou en partie toute
divulgaration à toute tierce personne et (2) doit utiliser l'information pour
la production ou la mise à jour.

PROPRIETARY INFORMATION
The information contained in this document is the property of BELDEN INC.
Except as specifically authorized in writing by BELDEN, INC, the holder of
this document: (1) shall keep all information contained herein confidential and
shall protect same in whole or in part from disclosure and dissemination to all
third parties and (2) shall use same for operating and maintenance purposes only.

PAGE / SHEET	1 DE/OF 1	
DESSIN NON À L'ÉCHELLE DRAWING NOT TO SCALE		
TITRE / TITLE NXM6KUSAB TYPE KEYCONNECT MOD T568A/B CAT6+		
NUMÉRO DE DESSIN/DRAWING NUMBER BELDEN-026		